

CF

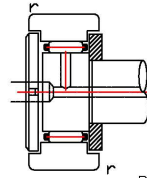

CF...UU

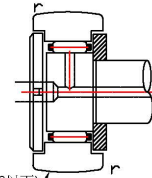

CF...R

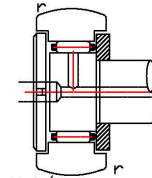

CF...UUR

R500(CF18以下)
R1000(CF20以上)

R500(CF18以下)
R1000(CF20以上)

型號				主要寸法(mm)										基本定格荷重		軌道負荷容量	極限速率	重量		
円筒外輪		球面外輪		d	D	S	B	B1	L	d1	d2	I	I1	r	F 最小	C	CO	kgf	rpm	grf
標準型	防塵型	標準型	防塵型													kgf	kgf			
CF 3A	CF 3UUA	CF 3RA	CF 3UURA	3	10	M3X0.5	7	8	17			5		0.3	6.8	130	72	120 50	47000	4.5
CF 4A	CF 4UUA	CF 4RA	CF 4UURA	4	12	M4X0.7	8	9	20			6		0.5	8.6	190	120	160 60	37000	7.5
CF 5	CF 5UU	CF 5R	CF 5UUR	5	13	M5X0.8	9	10	23	3.1		7.5		0.5	9.7	280	180	200 70	29000	10.5
CF 6	CF 6UU	CF 6R	CF 6UUR	6	16	M6X1	11	12	28	4		9		0.5	11	330	240	310 90	25000	18.5
CF 8	CF 8UU	CF 8R	CF 8UUR	8	19	M8X1.25	11	12	32	4		11		0.5	13	390	300	370 120	20000	28.5
CF 10	CF 10UU	CF 10R	CF 10UUR	10	22	M10X1.25	12	13	36	4		13		1	15	430	370	430 140	17000	45
CF 10-1	CF 10-1UU	CF 10-1R	CF 10-1UUR	10	26	M10X1.25	12	13	36	4		13		1	15	430	370	500 180	17000	60
CF 12	CF 12UU	CF 12R	CF 12UUR	12	30	M12X1.5	14	15	40	6	3	14	6	1.5	20	710	620	640 210	14000	95
CF 12-1	CF 12-1UU	CF 12-1R	CF 12-1UUR	12	32	M12X1.5	14	15	40	6	3	14	6	1.5	20	710	620	680 240	14000	105
CF 16	CF 16UU	CF 16R	CF 16UUR	16	35	M16X1.5	18	19.5	52	6	3	18	8	1.5	24	1040	1090	1020 270	10000	170
CF 18	CF 18UU	CF 18R	CF 18UUR	18	40	M18X1.5	20	21.5	58	6	3	20	10	1.5	26	1410	1690	1320 320	8500	250
CF 20	CF 20UU	CF 20R	CF 20UUR	20	52	M20X1.5	24	25.5	66	8	4	22	12	1.5	36	1940	2350	2110 700	7000	460
CF 20-1	CF 20-1UU	CF 20-1R	CF 20-1UUR	20	47	M20X1.5	24	25.5	66	8	4	22	12	1.5	36	1940	2350	1910 610	7000	385
CF 24	CF 24UU	CF 24R	CF 24UUR	24	62	M24X1.5	29	30.5	80	8	4	25	12	1.5	40	2600	3050	3120 900	6500	815
CF 24-1	CF 24-1UU	CF 24-1R	CF 24-1UUR	24	72	M24X1.5	29	30.5	80	8	4	25	12	1.5	40	2600	3050	3620 1110	6500	1140
CF 30	CF 30UU	CF 30R	CF 30UUR	30	80	M30X1.5	35	37	100	8	4	32	15	2	46	3470	5350	4800 1280	5000	1870
CF 30-1	CF 30-1UU	CF 30-1R	CF 30-1UUR	30	85	M30X1.5	35	37	100	8	4	32	15	2	46	3470	5350	5100 1390	5000	2030
CF 30-2	CF 30-2UU	CF 30-2R	CF 30-2UUR	30	90	M30X1.5	35	37	100	8	4	32	15	2	46	3470	5350	5400 1490	5000	2220

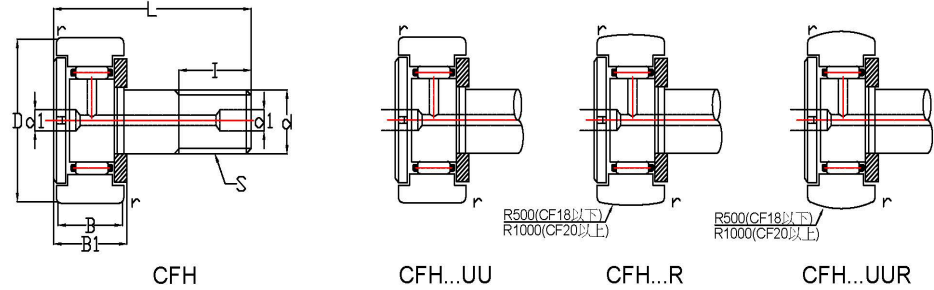

型號				主要寸法(mm)								基本定格荷重		軌道負荷容量	極限速率	重量		
凹筒外輪		球面外輪		d	D	S	B	B1	L	d1	I	e	r				C	CO
標準型	防腐型	標準型	防腐型									偏心量		kgf	kgf	kgf	rpm	grf
CFH 6	CFH 6UU	CFH 6R	CFH 6UUR	6	16	M6X1	11	12	28	4	9	0.25	0.5	330	240	310 90	25000	18.5
CFH 8	CFH 8UU	CFH 8R	CFH 8UUR	8	19	M8X1.25	11	12	32	4	11	0.25	0.5	390	300	370 120	20000	28.5
CFH10	CFH 10UU	CFH 10R	CFH 10UUR	10	22	M10X1.25	12	13	36	4	13	0.3	1	430	370	430 140	17000	45
CFH10-1	CFH 10-1UU	CFH 10-1R	CFH 10-1UUR	10	26	M10X1.25	12	13	36	4	13	0.3	1	430	370	500 180	17000	60
CFH 12	CFH 12UU	CFH 12R	CFH 12UUR	12	30	M12X1.5	14	15	40	6	14	0.4	1.5	710	620	640 210	14000	95
CFH 12-1	CFH 12-1UU	CFH 12-1R	CFH 12-1UUR	12	32	M12X1.5	14	15	40	6	14	0.4	1.5	710	620	680 240	14000	105
CFH 16	CFH 16UU	CFH 16R	CFH 16UUR	16	35	M16X1.5	18	19.5	52	6	18	0.5	1.5	1040	1090	1020 270	10000	170
CFH 18	CFH 18UU	CFH 18R	CFH 18UUR	18	40	M18X1.5	20	21.5	58	6	20	0.6	1.5	1410	1690	1320 320	8500	250
CFH 20	CFH 20UU	CFH 20R	CFH 20UUR	20	52	M20X1.5	24	25.5	66	8	22	0.7	1.5	1940	2350	2110 700	7000	460
CFH 20-1	CFH 20-1UU	CFH 20-1R	CFH 20-1UUR	20	47	M20X1.5	24	25.5	66	8	22	0.7	1.5	1940	2350	1910 610	7000	385
CFH 24	CFH 24UU	CFH 24R	CFH 24UUR	24	62	M24X1.5	29	30.5	80	8	25	0.8	1.5	2600	3050	3120 900	6500	815
CFH 24-1	CFH 24-1UU	CFH 24-1R	CFH 24-1UUR	24	72	M24X1.5	29	30.5	80	8	25	0.8	1.5	2600	3050	3620 1110	6500	1140
CFH 30	CFH 30UU	CFH 30R	CFH 30UUR	30	80	M30X1.5	35	37	100	8	32	1	2	3470	5350	4800 1280	5000	1870
CFH 30-1	CFH 30-1UU	CFH 30-1R	CFH 30-1UUR	30	85	M30X1.5	35	37	100	8	32	1	2	3470	5350	5100 1390	5000	2030
CFH 30-2	CFH 30-2UU	CFH 30-2R	CFH 30-2UUR	30	90	M30X1.5	35	37	100	8	32	1	2	3470	5350	5400 1490	5000	2220

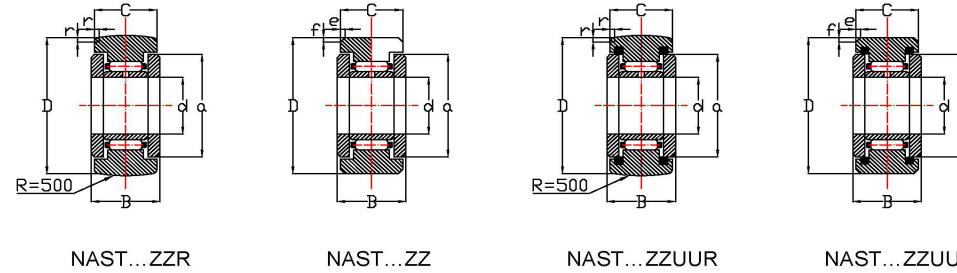

型號				主要寸法(mm)								基本定格荷重		極限速率	重量
Shield type		Sealed type		d	D	B	C	a	e	f	r	C	CO		
Crowned outer ring	Cylindrical outer ring	Crowned outer ring	Cylindrical outer ring									kgf	kgf	rpm	grf
NAST 6ZZR	NAST 6ZZ	NAST 6ZZUUR	NAST 6ZZUU	6	19	14	13.8	14	2.5	0.8	0.3	420	460	17 000	24.5
NAST 8ZZR	NAST 8ZZ	NAST 8ZZUUR	NAST 8ZZUU	8	24	14	13.8	17.5	2.5	0.8	0.6	580	600	14000	39
NAST 10ZZR	NAST 10ZZ	NAST 10ZZUUR	NAST 10ZZUU	10	30	16	15.8	23.5	2.5	0.8	1	1000	990	12000	65
NAST 12ZZR	NAST 12ZZ	NAST 12ZZUUR	NAST 12ZZUU	12	32	16	15.8	25.5	2.5	0.8	1	1070	1110	11000	75
NAST 15ZZR	NAST 15ZZ	NAST 15ZZUUR	NAST 15ZZUU	15	35	16	15.8	29	2.5	0.8	1	1260	1460	8500	83
NAST 17ZZR	NAST 17ZZ	NAST 17ZZUUR	NAST 17ZZUU	17	40	20	19.8	32.5	3	1	1	1790	2130	7500	135
NAST 20ZZR	NAST 20ZZ	NAST 20ZZUUR	NAST 20ZZUU	20	47	20	19.8	38	3	1	1	1980	2500	7000	195
NAST 25ZZR	NAST 25ZZ	NAST 25ZZUUR	NAST 25ZZUU	25	52	20	19.8	43	3	1	1	2120	2890	5500	225
NAST 30ZZR	NAST 30ZZ	NAST 30ZZUUR	NAST 30ZZUU	30	62	25	24.8	50.5	4	1.2	1	3110	4630	4500	400
NAST 35ZZR	NAST 35ZZ	NAST 35ZZUUR	NAST 35ZZUU	35	72	25	24.8	53.5	4	1.2	1	3300	5170	4000	550
NAST 40ZZR	NAST 40ZZ	NAST 40ZZUUR	NAST 40ZZUU	40	80	26	25.8	61.5	4	1.2	1.5	3660	6230	3500	710
NAST 45ZZR	NAST 45ZZ	NAST 45ZZUUR	NAST 45ZZUU	45	85	26	25.8	66.5	4	1.2	1.5	3810	6770	3000	760
NAST 50ZZR	NAST 50ZZ	NAST 50ZZUUR	NAST 50ZZUU	50	90	26	25.8	76	4	1.2	1.5	3970	7310	3000	830

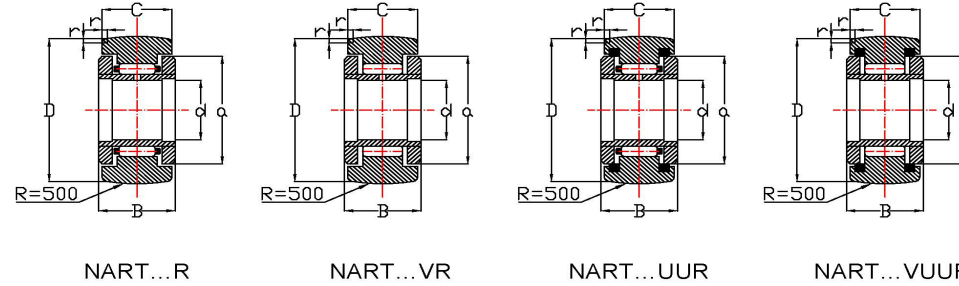

型號		主要寸法(mm)						基本定格荷重		極限速率	重量		
Shield type		Sealed type		d	D	B	C	a	r	C	CO	rpm	grf
Crowned outer ring	Cylindrical outer ring	Crowned outer ring	Cylindrical outer ring							kgf	kgf		
NART 5R		NART 5UUR		5	16	12	11	12	0.3	370	380	21000	14.5
	NART 5VR		NART 5VUUR	5	16	12	11	12	0.3	690	850	11000	15.1
NART 6R		NART 6UUR		6	19	12	11	14	0.3	430	480	17000	20.5
	NART 6VR		NART 6VUUR	6	19	12	11	14	0.3	780	1050	9000	21.5
NART 8R		NART 8UUR		8	24	15	14	17.5	0.3	580	600	14000	41.5
	NART 8VR		NART 8VUUR	8	24	15	14	17.5	0.3	1200	1590	7500	42.5
NART 10R		NART 10UUR		10	30	15	14	23.5	0.6	820	770	12000	64.5
	NART 10VR		NART 10VUUR	10	30	15	14	23.5	0.6	1590	1840	6000	66.5
NART 12R		NART 12UUR		12	32	15	14	25.5	0.6	870	860	10000	71
	NART 12VR		NART 12VUUR	12	32	15	14	25.5	0.6	1710	2090	5500	73
NART 15R		NART 15UUR		15	35	19	18	29	0.6	1400	1670	8500	102
	NART 15VR		NART 15VUUR	15	35	19	18	29	0.6	2560	3710	4500	106
NART 17R		NART 17UUR		17	40	21	20	32.5	1	1790	2140	7500	149
	NART 17VR		NART 17VUUR	17	40	21	20	32.5	1	3270	4720	4000	155
NART 20R		NART 20UUR		20	47	25	24	38	1	2340	3130	6500	250
	NART 20VR		NART 20VUUR	20	47	25	24	38	1	4250	6860	3500	255
NART 25R		NART 25UUR		25	52	25	24	43	1	2520	3610	5500	285
	NART 25VR		NART 25VUUR	25	52	25	24	43	1	4640	8060	3000	295
NART 30R		NART 30UUR		30	62	29	28	50.5	1	3420	5240	4500	470
	NART 30VR		NART 30VUUR	30	62	29	28	50.5	1	6110	11300	2500	485
NART 35R		NART 35UUR		35	72	29	28	53.5	1	3640	5850	4000	640
	NART 35VR		NART 35VUUR	35	72	29	28	53.5	1	6430	12400	2000	655
NART 40R		NART 40UUR		40	80	32	30	61.5	1	4580	8300	3500	845
	NART 40VR		NART 40VUUR	40	80	32	30	61.5	1	7780	16700	1800	865
NART 45R		NART 45UUR		45	85	32	30	66.5	1	4770	9030	3000	915
	NART 45VR		NART 45VUUR	45	85	32	30	66.5	1	8190	18500	1600	935
NART 50R		NART 50UUR		50	90	32	30	76	1	4960	9750	3000	980
	NART 50VR		NART 50VUUR	50	90	32	30	76	1	8590	20200	1500	1010

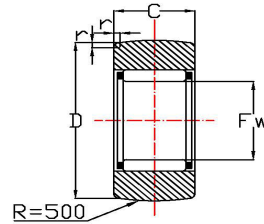

RNAST...R

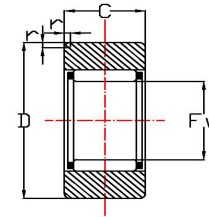

RNAST

型號		主要寸法(mm)				基本定格荷重		極限速率	重量
Identification number		Fw	D	C	r	C	CO		
Crowned outer ring	Cylindrical outer ring					kgf	kgf	rpm	grf
RNAST 5R	RNAST 5	7	16	7.8	0.3	280	240	24000	8.9
RNAST 6R	RNAST 6	10	19	9.8	0.3	420	460	17000	13.9
RNAST 8R	RNAST 8	12	24	9.8	0.6	580	600	14000	23.5
RNAST 10R	RNAST 10	14	30	11.8	1	1000	990	12000	42.5
RNAST 12R	RNAST 12	16	32	11.8	1	1070	1110	11000	49.5
RNAST 15R	RNAST 15	20	35	11.8	1	1260	1460	8500	50
RNAST 17R	RNAST 17	22	40	15.8	1	1790	2130	7500	90
RNAST 20R	RNAST 20	25	47	15.8	1	1980	2500	7000	135
RNAST 25R	RNAST 25	30	52	15.8	1	2120	2890	5500	152
RNAST 30R	RNAST 30	38	62	19.8	1	3110	4630	4500	255
RNAST 35R	RNAST 35	42	72	19.8	1	3300	5170	4000	375
RNAST 40R	RNAST 40	50	80	19.8	1.5	3660	6230	3500	420
RNAST 45R	RNAST 45	55	85	19.8	1.5	3810	6770	3000	460
RNAST 50R	RNAST 50	60	90	19.8	1.5	3970	7310	3000	500

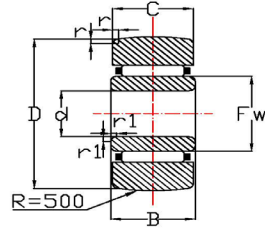

RNAS...R

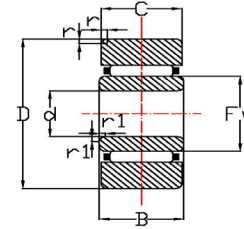

RNAS

型號		主要寸法(mm)						基本定格荷重		極限速率	重量	
Identification number		d	D	B	C	r	r1	Fw	C	CO	rpm	grf
Crowned outer ring	Cylindrical outer ring								kgf	kgf		
NAST 6R	NAST 6	6	19	10	9.8	0.3	0.3	10	420	460	17000	17.8
NAST 8R	NAST 8	8	24	10	9.8	0.6	0.3	12	580	600	14000	28
NAST 10R	NAST 10	10	30	12	11.8	1	0.3	14	1000	990	12000	49.5
NAST 12R	NAST 12	12	32	12	11.8	1	0.3	16	1070	1110	11000	58
NAST 15R	NAST 15	15	35	12	11.8	1	0.3	20	1260	1460	8500	62
NAST 17R	NAST 17	17	40	16	15.8	1	0.3	22	1790	2130	7500	109
NAST 20R	NAST 20	20	47	16	15.8	1	0.3	25	1980	2500	7000	157
NAST 25R	NAST 25	25	52	16	15.8	1	0.3	30	2120	2890	5500	180
NAST 30R	NAST 30	30	62	20	19.8	1	0.6	38	3110	4630	4500	320
NAST 35R	NAST 35	35	72	20	19.8	1	0.6	42	3300	5170	4000	440
NAST 40R	NAST 40	40	80	20	19.8	1.5	1	50	3660	6230	3500	530
NAST 45R	NAST 45	45	85	20	19.8	1.5	1	55	3810	6770	3000	580
NAST 50R	NAST 50	50	90	20	19.8	1.5	1	60	3970	7310	3000	635